

SWISS+TECH®

First in Key Ring Products™



Patent 5,491,856 and patent pending. Made in China.
SWISS+TECH® is a registered trademark, and
First in Key Ring Products™ and Micro-Pro™ are
trademarks of Crestwood Partners, LLC.

© 2008 Crestwood Partners, LLC
Cleveland, OH 44143 1-800-414-8799

#74026

Micro-Pro™ XL1100

11 Tools in One:

1. Flashlight
2. Key Ring
3. Pliers
4. Wire Cutter
5. Wire Stripper
6. Sheet Shear
7. 1/4-Inch Rule



8. #1 Phillips Screwdriver
9. #1 Flat Screwdriver
10. #2 Phillips Screwdriver
11. #2 Flat Screwdriver

Micro-Pro™ XL900

9 Tools in One:

1. Flashlight
2. Key Ring
3. Pliers
4. Wire Cutter
5. Wire Stripper
6. Sheet Shear
7. 1/4-Inch Rule

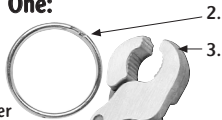

8. #2 Flat Screwdriver
9. #2 Phillips Screwdriver

Working Positions

XL1100 and XL900:

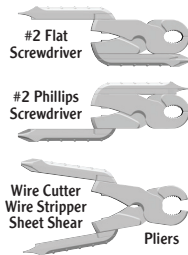

XL1100 Only:

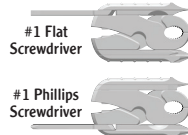

Unlocking Instructions

1. Swing screwdriver tips toward you.
2. Pull pliers handles outward to open jaws and remove from "dock."

To reattach, close pliers on dock or key ring and swing screwdrivers to locked position (Position 1).

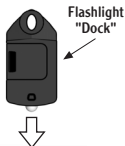
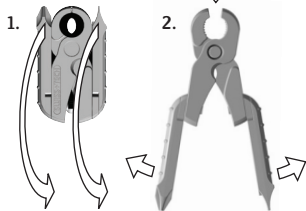

Micro-Light Tool Dock



Easy to Use: Press and hold button to turn on flashlight.

To attach key ring to Micro-Light Tool Dock, spread wire end, slide carefully into hole, and continue through until completely on.



Battery Replacement

1. With micro-tool removed from Micro-Light dock, press and slide battery cover off.

2. Remove old batteries.

3. Replace with two new CR1025 3V lithium batteries or equivalent. Battery closest to light bulb goes positive (+) side up. Battery farthest from light bulb goes positive (+) side down.

4. Replace back cover.

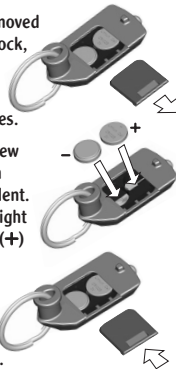

DO NOT dispose of batteries in fire, batteries may explode or leak.

SWISS+TECH® Limited LIFETIME Warranty

This product is covered by a Limited Lifetime Warranty to the original purchaser in that this product is free from defects in workmanship and materials. During the warranty period, this product will either be repaired or replaced with a product of equal or greater value.

Damage through normal wear and tear (including battery expiration and surface coatings), repair or alteration, misuse, abuse, neglect, accident, improper storage and handling, fire, negligence, improper cleaning, circumstances not directly attributable to manufacturing defects, or act of God is not included.

THIS WARRANTY IS IN LIEU OF ALL OTHER WARRANTIES, EXPRESS OR IMPLIED, INCLUDING BUT NOT LIMITED TO, IMPLIED WARRANTY OF MERCHANTABILITY OR FITNESS FOR A PARTICULAR ISSUE.

This warranty gives you specific legal rights, and you may also have other rights which vary from state to state.

Simply return your SWISS+TECH® brand product postpaid and insured to: Swiss+Tech Products
701 Beta Drive, Unit 5
Cleveland, Ohio 44143

More information:

800.414.8799 or www.swisstechtools.com