

Mobile-Tech™ Smartphone Tool Case

Impact-resistant case protects your phone, acts as a stand and keeps all your tools readily available.

Soft-touch finish provides a great feel and a secure grip.

1. Phone/tool case
2. #1 flathead screwdriver
3. #2 flathead screwdriver
4. #1 Phillips screwdriver
5. #2 Phillips screwdriver
6. Spring-action scissors
7. Toothpick
8. Writing pen
9. Nail file
10. Nail cleaner
11. Cuticle tool
12. Bottle opener
13. Tweezers



Solid stainless steel tools.

These tools comply with TSA guidelines for airplane carry-on. However, even if an item is generally permitted, it may be subject to additional screening or not allowed through the checkpoint if it triggers an alarm during the screening process, appears to have been tampered with, or poses other security concerns. The final decision rests with TSA on whether to allow any items on the plane.



How to position tools in the case for easy removal:

- A. Position scissors in the leftmost slot with thumbhole to the right.
- B. Position toothpick with protrusion facing up.
- C. Position pen with protrusion facing to the side.
- D. Position fingernail tool so bottle-opener end is facing out and file is facing up.
- E. Position tweezers with open end in and thumbnail notch out.
- F. Position screwdriver tool so thumbnail notch is up and facing out.

Installation Instructions

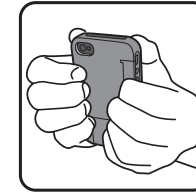

Position phone in tool case so its openings align with camera lens and control buttons. Snap into place.

Removal Instructions

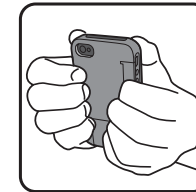

1. With the screen facing toward you, press your fingers against the back of the case.

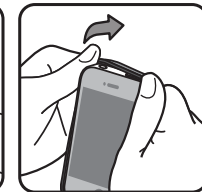

2. Use your thumbs to pry open the top corners of your case away from your phone.

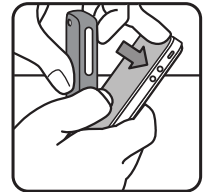

3. When the two top corners are free, your phone will angle out of the case easily.

Limited One Year Warranty

This product is covered by a limited one year warranty to the original purchaser in that this product is free from defects in workmanship and materials. During the warranty period, these products will either be repaired or replaced with a product of equal or greater value, excluding any custom engraving or printing.

Damage through normal wear and tear (including battery expiration and surface coatings), repair or alteration, misuse, abuse, neglect, accident, improper storage and handling, fire, negligence, improper cleaning, circumstances not directly attributable to manufacturing defects, or act of God is not included.

THIS WARRANTY IS IN LIEU OF ALL OTHER WARRANTIES, EXPRESS OR IMPLIED, INCLUDING BUT NOT LIMITED TO, IMPLIED WARRANTY OF MERCHANTABILITY OR FITNESS FOR A PARTICULAR USE.

This warranty gives you specific legal rights, and you may also have other rights which vary from state to state. Simply return your SWISS+TECH™ brand product postpaid and insured to: Swiss+Tech Products, 30725 Solon Industrial Pkwy, Solon, OH 44139 USA